

Compressors, Chillers & Condensers

HERMETIC COMPRESSOR ACCESSORIES

COMPRESSOR BOLTS

RCD PART NO*	SPEC NO	'A' (in)	'B' (in)	'C' OD (in)	'D' THREAD (in)	COMPRESSOR USAGE
P041-5301 & #31	AH01AM210	1.55	1.125	0.436	5/16-18-D	--
P041-5302 & #31	AH09AM202	0.958	0.646	0.436	5/16-12-B	TEC.CARL. COPE.
P041-5309	AH01EM205	2	1.5	0.418	5/16-18-D	TEC.
P041-5310	AH01AM208	1.375	0.875	0.47	5/16-18-D	TEC. TOSHIBA

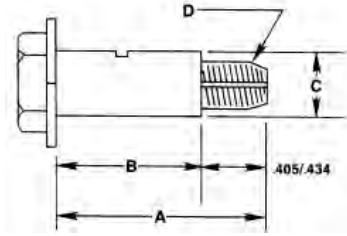

*All are packaged in quantities of (12).

COMPRESSOR GROMMET SLEEVE

SPEC NO	RCD PART NO*	'A' (in)	'B' OD (in)	'C' ID (in)
KA56TS022	P041-5201	0.906	0.44	0.34

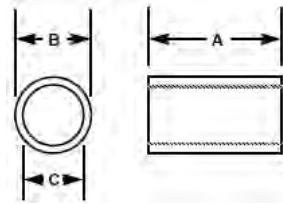

*All are packaged in quantities of (12).

RESIDENTIAL MUFFLERS 2 - 5 TON

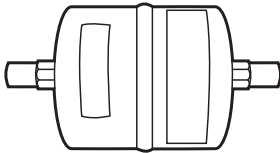

RCD PART NO*	NOM TON CAR	OD (in)	INLET* DIM (in)
LM10KH001	2	2-5/16	3/8
LM10HK010	3	2-15/16	1/2
LM680001	5	3	1/2

*Inlet and outlet dimensions are specified as I.D. unless otherwise indicated.

**90° elbow in inlet.

•• Supersedes LM10HK001, 002.

COMPRESSOR TERMINAL CONNECTOR

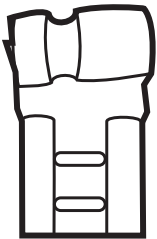

• Quick connect designed to fit Hermetic compressor terminal
P/N: HY61AM094

SINGLE FUNCTION TIME GUARD

SIZE: 3.4H x 3.4W x 1.7D

- Time guard II
- Solid state controlled recycle delay timer
- Operation: in the event of any power interruption, Time guard II provides a 5 min. delay which prevents rapid cycling of the compressor
- Wiring diagram is printed on time guard
- Operating volts: 24
- Load current @ 24v-1 amp
- Switching arrangement: SPST-N.O.

PART NO - HN67PA024

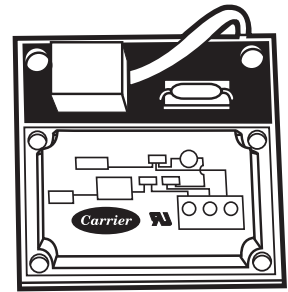

Compressors,
Chillers, Condensers

Motors

Electrical

Heating
Components

Indoor Air
Quality

Thermostats

Oils &
Chemicals

Accessories, Supplies
& Commodities

Tools &
Instruments

Refrigeration