

# COMPRESSORS, CHILLERS & CONDENSERS

## COMPRESSOR VALVES & KITS

### MUELLER COMPRESSOR VALVES & KITS



#### THE INDUSTRY STANDARD

Mueller's compressor valves demonstrate a backseating design, constructed so that the stem forms a seal against a seat whether the stem is full forward or backward. This design allows complete isolation of service when the valve is either fully open or fully closed. In the intermediate position, specialized packing allows gauge and charging port caps and plugs to be accessed without refrigerants loss. Cross reference information is provided to assist in the selection process for all major compressor manufacturers in the industry.

Copeland No.	Kit	Copeland No.	Kit
998-0510-04	A 17510	998-0510-14	A 17517
998-0510-05	A 17511	998-0510-15	A 17518
998-0510-06	A 17512	998-0510-16	A 17519
998-0510-07	A 17513	998-0510-17	A 17520
998-0510-09	A 17525	998-0510-18	A 17521
998-0510-10	A 17527	998-0510-19	A 17522
998-0510-11	A 17526	998-0510-20	A 17523
998-0510-12	A 17515	998-0510-21	A 17524
998-0510-13	A 17516		

#### ADVANTAGES:

- Complete service kit including valve body, mounting bolts, cap, and gaskets.
- Compatible with all new refrigerants and oils.
- 700 psig maximum working pressure
- All valves 100% tested.
- Recognized under component program of underwriters laboratories for use in the USA and Canada.

#### BRASS COMPRESSOR VALVES

Double Port - 45° Flare Type - Steel Cap

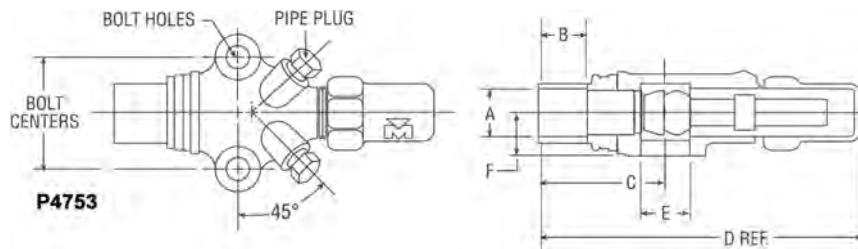

PART NO	Kit	A	C	D	E	F	BOLT CENTERS	DIA BOLT HOLES	PIPE PLUG SIZE	FLANGE THICKNESS	Valve Wt	Kit Wt
A 16302	A 17518	3/8	1-3/4	4-7/16	9/16	5/8	1-5/8	11/32	1/8	7/8	1.20	1.24
A 16303	A 17519	1/2	1-7/8	4-11/16	9/16	5/8	1-5/8	11/32	1/8	7/8	1.17	1.20
A 16304	A 17520	5/8	2	4-13/16	9/16	5/8	1-5/8	11/32	1/8	7/8	1.23	1.27