

# COMPRESSORS, CHILLERS & CONDENSERS

## COMPRESSOR VALVES & KITS

### MUELLER COMPRESSOR VALVES & KITS

#### BRASS COMPRESSOR VALVES

Double Port - Solder Type - Steel Cap

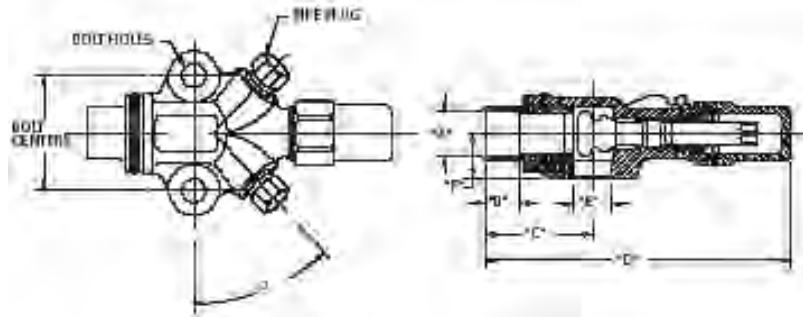

PART NO	Kit	A	B	C	D	E	F	BOLT CENTERS	DIA BOLT HOLES	PIPE PLUG SIZE	FLANGE THICKNESS	Valve Wt	Kit Wt
A 16307	A 17510	3/8	5/16	1-1/4	4-5/64	9/16	5/8	1-5/8	11/32	1/8	7/8	0.69	0.73
A 16308	A 17511	1/2	3/8	1-13/32	4-13/64	9/16	5/8	1-5/8	11/32	1/8	7/8	0.86	0.89
A 16309	A 17512	5/8	1/2	1-1/2	4-1/2	9/16	5/8	1-5/8	11/32	1/8	7/8	0.88	0.92

Straight Port - Solder Type - Plastic Cap

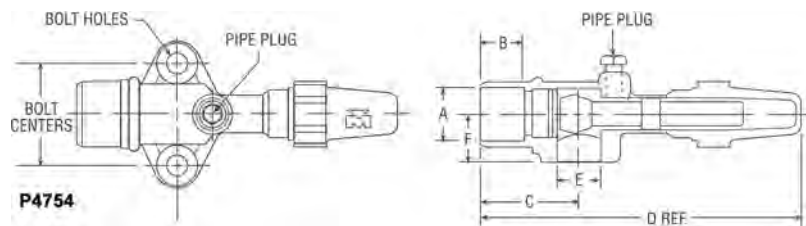

PART NO	Kit	A	B	C	D	E	F	BOLT CENTERS	DIA BOLT HOLES	PIPE PLUG SIZE	FLANGE THICKNESS	Valve Wt	Kit Wt
A 16310	A 17517	3/4	5/8	1-29/32	6-9/16	13/16	7/8	1-5/8	11/32	1/8	1-21/64	1.64	1.69
A 16311	A 17515	7/8	3/4	1-31/32	6-9/16	13/16	7/8	1-5/8	11/32	1/8	1-21/64	1.63	1.67
A 16317	A 17528	7/8	3/4	1-31/32	6-1/2	13/16	7/8	1-5/8	11/32	1/8	1-21/64	1.63	1.68
B 32197	A 17529	7/8	3/4	1-31/32	6-9/16	13/16	7/8	1-3/4	11/32	1/8	1-21/64	1.42	1.69
A 15500	--	1-1/8	29/32	2-1/16	6-9/16	13/16	7/8	1-5/8	11/32	1/8	1-21/64	1.66	--
A 16312	A 17516	1-1/8	29/32	2-1/16	6-9/16	13/16	7/8	1-5/8	11/32	1/8	1-21/64	1.66	1.71
B 33367	A 17530	1-1/8	29/32	2-17/64	6-9/16	1-1/8	7/8	1-3/4	11/32	1/4	1-21/64	--	--

Flange Union - Solder Type - Brass Cap

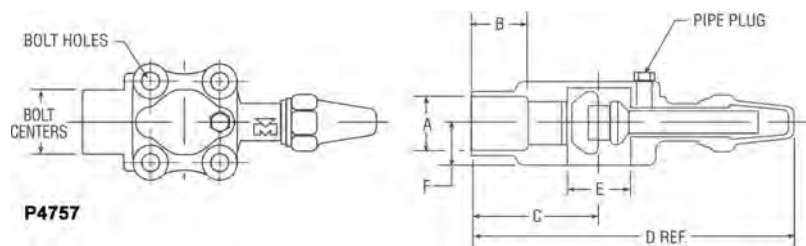

PART NO	Kit	A	B	C	D	E	F	BOLT CENTERS	DIA BOLT HOLES	PIPE PLUG SIZE	Flange Bolt Centers	FLANGE THICKNESS	Valve Wt	Kit Wt
A 16313	--	3/4	5/8	2-5/16	7-11/32	1-1/4	1-1/4	2-3/4	17/32	1/8	1-5/8	1	3.93	--
A 16314	A 17527	7/8	3/4	2-5/16	7-11/32	1-1/4	1-1/4	2-3/4	17/32	1/8	1-5/8	1	3.90	4.05
A 16315	A 17525	1-1/8	29/32	2-15/32	7-1/2	1-1/4	1-1/4	2-3/4	17/32	1/8	1-5/8	1	3.88	4.03
A 16316	A 17526	1-3/8	31/32	2-15/32	7-1/2	1-1/4	1-1/4	2-3/4	17/32	1/8	1-5/8	1	3.66	3.80

# COMPRESSORS, CHILLERS & CONDENSERS

## COMPRESSOR VALVES & KITS

### MUELLER COMPRESSOR VALVES & KITS

#### BRASS COMPRESSOR VALVES

Straight Port - 45° Flare Type - Plastic Cap

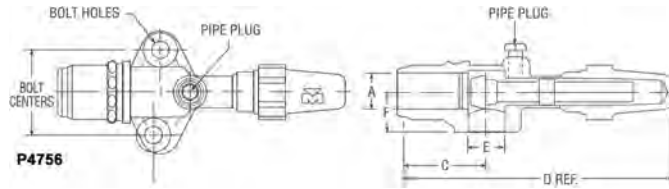

PART NO	A	C	D	E	F	BOLT CENTERS	DIA BOLT HOLES	PIPE PLUG SIZE	FLANGE THICKNESS	Valve Wt
A 13166	3/4	2-3/8	7	13/16	7/8	1-5/8	11/32	1/8	1-1/4	1-7/8

4-Bolt Mounting Style - Solder Type - Flat Gasket Surface - Plastic Cap

PART NO	Kit	A	B	C	D	E	F	BOLT CENTERS	DIA BOLT HOLES	PIPE PLUG SIZE	Valve Wt	Kit Wt
B 32807	A 17532	1-1/8	29/32	2-23/32	7-5/8	1-9/16	1	2-1/2	17/32	1/4	3.88	4.03
B 32808	A 17533	1-3/8	31/32	2-23/32	7-5/8	1-9/16	1	2-1/2	17/32	1/4	3.66	3.80
B 32930	A 17534	1-5/8	1-3/32	2-7/8	7-5/8	1-9/16	1-1/32	2-1/2	17/32	1/4	3.90	4.05

#### CAST IRON COMPRESSOR VALVES

4-Bolt - Cast Iron Compressor Valves

PART NO	Kit	A	B	C	D	E	F	BOLT CENTERS	DIA BOLT HOLES	PIPE PLUG SIZE	Flange Bolt Centers	Seal Cap Material	Valve Wt	Kit Wt
B 33813	--	1-3/8	31/32	4-13/32	9-29/32	2-1/8	2-3/4	2-1/2	17/32	1/4	2-1/8	Cast Iron	9.43	--
A 15246	--	1-5/8	1-3/32	3-61/64	9-15/32	2-1/8	2-3/4	2-1/2	17/32	1/4	2-1/8	Valox	9.37	--
A 16321	A 17513	1-5/8	1-3/32	4-19/32	10-3/64	2-1/8	2-3/4	2-1/2	17/32	1/4	2-1/8	Valox	8.72	8.92
A 16367	A 17524	1-5/8	1-3/32	5-1/4	11-29/32	2-17/32	3-7/32	3-1/16	11/16	1/4	3-1/16	Valox	18.20	18.61
A 16496	--	1-5/8	1-3/32	3-61/64	9-15/32	2-1/8	2-3/4	2-1/2	17/32	1/4	2-1/8	Valox	8.74	--
B 32337	--	1-5/8	1-3/32	3-61/64	9-15/32	2-1/8	2-3/4	2-1/2	17/32	1/4	2-1/8	Valox	9.07	--
B 33770	--	1-5/8	1-3/32	4-19/32	10-1/64	2-1/8	2-3/4	2-1/2	17/32	1/4	2-1/8	Cast Iron	8.46	--
B 33842	--	1-5/8	1-3/32	5-1/4	11-29/32	2-17/32	3-7/32	3-1/16	11/16	1/4	3-1/16	Cast Iron	18.97	--
B 33784	--	2	1-9/32	5-1/64	11-55/64	2-17/32	3-7/32	3-1/16	11/16	1/4	3-1/16	Valox	16.42	--
A 15586	A 17535	2-1/8	1-5/16	5-1/16	11-61/64	2-17/32	3-7/32	3-1/16	11/16	1/4	3-1/16	Valox	18.28	6.69
A 16324	A 17523	2-1/8	1-5/16	5-1/16	11-61/64	2-17/32	3-7/32	3-1/16	11/16	1/4	3-1/16	Valox	18.28	18.69
A 16493	--	2-1/8	1-5/16	5-1/16	11-61/64	2-17/32	3-7/32	3-1/16	11/16	1/4	3-1/16	Valox	17.71	--
B 33572	--	2-1/8	1-5/16	5-1/16	11-61/64	2-17/32	3-7/32	3-1/16	11/16	1/4	3-1/16	Valox	17.49	--
B 34429	--	2-1/8	1-5/16	5-1/16	11-61/64	2-17/32	3-7/32	3-1/16	11/16	1/4	3-1/16	Valox	17.28	--
B 34671	--	2-1/8	1-5/16	5-1/16	11-61/64	2-33/64	3-7/32	3-1/16	11/16	1/4	3-1/16	Valox	17.28	--
A 15587	--	2-5/8	1-9/32	5-1/64	12-1/16	2-17/32	3-7/32	3-1/16	11/16	1/4	3-1/16	Valox	20.30	--
A 16366	A 17522	2-5/8	1-15/32	6-1/2	15-1/8	3-11/32	4-5/32	3-7/8	11/16	1/4	3-7/8	Cast Iron	33.18	3.73
B 33568	--	2-5/8	1-9/32	5-1/64	11-29/32	2-17/32	3-7/32	3-1/16	11/16	1/4	3-1/16	Valox	20.23	--
B 34314	--	2-5/8	1-15/32	6-1/2	15-1/8	3-11/32	4-5/32	3-7/8	11/16	1/4	3-7/8	Cast Iron	30.80	--
B 34582	--	2-5/8	1-17/64	5-3/64	11-29/32	2-17/32	3-7/32	3-1/16	11/16	1/4	3-1/16	Valox	--	--
B 34661	--	2-5/8	1-15/32	6-1/2	15-1/8	3-11/32	4-5/32	3-7/8	11/16	1/4	3-7/8	Cast Iron	30.80	--
A 15588	--	3-1/8	1-7/32	5-15/16	14-39/64	3-11/32	4-5/32	3-7/8	11/16	1/4	3-7/8	Cast Iron	33.22	--
A 16365	A 17521	3-1/8	1-7/32	5-15/16	14-39/64	3-11/32	4-5/32	3-7/8	11/16	1/4	3-7/8	Cast Iron	33.22	33.77
B 33569	--	3-1/8	1-7/32	5-15/16	14-39/64	3-11/32	4-5/32	3-7/8	11/16	1/4	3-7/8	Cast Iron	32.38	--
A 17496	--	3-5/8	2-1/16	7	16-19/64	3-7/8	4-35/64	4-1/4	11/16	1/4	4-1/4	Cast Iron	34.01	--
B 33788	--	3-5/8	2-1/16	7	16-19/64	3-7/8	4-35/64	4-1/4	11/16	1/4	4-1/4	Cast Iron	34.01	--
B 34315	--	3-5/8	2-1/16	7	16-19/64	3-7/8	4-35/64	4-1/4	11/16	1/4	4-1/4	Cast Iron	40.51	--
B 34670	--	3-5/8	2-1/16	7	16-19/64	3-7/8	4-9/64	4-1/4	11/16	1/4	4-1/4	Cast Iron	40.51	--
A 15589	--	4-1/8	1-31/32	7-7/32	17-1/2	4-3/8	5-1/8	4-3/16	13/16	1/4	4-13/16	Cast Iron	49.80	--

# COMPRESSORS, CHILLERS & CONDENSERS

## COMPRESSOR VALVES & KITS

### MUELLER COMPRESSOR VALVES & KITS

#### CAST IRON COMPRESSOR VALVES

4-Bolt - Cast Iron Compressor Valves Without Flange

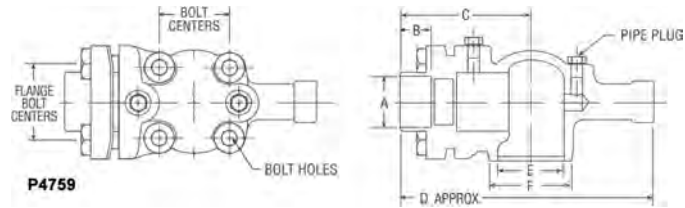

PART NO	C	D	E	F	BOLT CENTERS	DIA BOLT HOLES	PIPE PLUG SIZE	Flange Bolt Centers	Seal Cap Material	Valve Wt
B 33793	3-9/32	10-11/64	2-17/32	3-7/32	3-1/16	11/16	1/4	3-1/16	Valox	12.58
B 33794	3-25/32	12-7/16	3-11/32	4-5/32	3-7/8	11/16	1/4	3-7/8	Cast Iron	22.05
B 34183	2-11/16	8-3/32	2-1/8	2-3/4	2-1/2	17/32	1/4	2-1/8	Valox	6.91
B 34497	3-63/64	13-1/4	3-7/8	4-35/64	4-1/4	11/16	1/4	4-1/4	Cast Iron	34.00
B 34498	3-9/32	10-1/8	2-17/32	3-7/32	3-1/16	11/16	1/4	3-1/16	Valox	17.28
B 34715	3-25/32	13	3-11/32	4-5/32	3-7/8	11/16	1/4	3-7/8	Steel	22.05
B 34761	3-9/32	10-11/64	2-17/32	3-1/32	3-1/16	11/16	1/4	3-1/16	Valox	13.00
B 34929**	4-9/16	14-53/64	4-3/8	5-1/8	4-13/16	13/16	1/4	4-13/16	Cast Iron	37.00
B 35049	3-9/32	10-1/8	2-17/32	3-7/32	3-1/16	11/16	1/4	3-1/16	Valox	12.97

\*\* Does not include coupling and bolts

4-Bolt - Cast Iron Flanges

PART NO	A	B	C	D	E	F	BOLT CENTERS	DIA BOLT HOLES	PIPE PLUG SIZE	Flange Bolt Centers	Valve Wt
B 34987*	2-5/8	1-15/32	6-1/2	12 35/64	3-11/32	4-5/32	3-7/8	11/16	1/4	3-7/8	28.50
B 34988*	3-5/8	2-1/16	7	13 39/64	3-7/8	4-9/16	4-1/4	11/16	1/4	4-1/4	33.50

\* Does not include Seat and Stem

Ammonia Valves

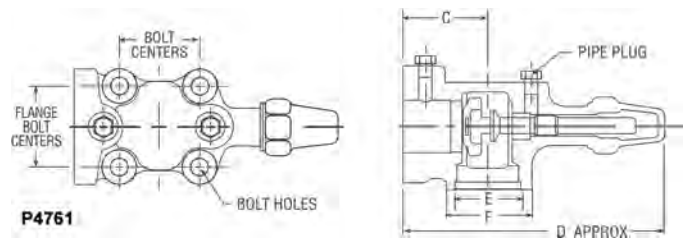

PART NO	C	D	E	F	BOLT CENTERS	DIA BOLT HOLES	Flange Bolt Centers	Seal Cap Material	Valve Wt
B 35308	3-9/32	10-11/64	2-17/32	3-7/32	3-1/16	11/16	3-1/16	Valox	13.02
B 35358	3-25/32	12-7/16	3-11/32	4-5/32	3-7/8	11/16	3-1/16	Cast Iron	22.05

# COMPRESSORS, CHILLERS & CONDENSERS

## COMPRESSOR VALVES & KITS

### MUELLER COMPRESSOR VALVES & KITS

#### CAST IRON COMPRESSOR VALVES

Ammonia Valves

Torques To Seal (ft. - lbs.)

PART NO	Front Seat	Back Seat	Pack Gland	Pipe Plug	Plastic Cap	Brass Cap	Steel Cap	Cast Iron
A 13166								
A 15085	22 - 40	25 - 45	15 - 25	2 - 3 Threads Exposed	Hand Tight	40 - 50	NA	NA
A 15246	45 - 65	45 - 65	25 - 35	2 - 3 Threads Exposed	Hand Tight	NA	NA	NA
A 15500	22 - 40	25 - 45	15 - 25	2 - 3 Threads Exposed	Hand Tight	NA	NA	NA
A 15586	45 - 65	45 - 65	35 - 45	2 - 3 Threads Exposed	Hand Tight	NA	NA	Hand Tight
A 15587	45 - 65	45 - 65	35 - 45	2 - 3 Threads Exposed	Hand Tight	NA	NA	Hand Tight
A 15588	45 - 70	45 - 65	55 - 70	2 - 3 Threads Exposed	Hand Tight	NA	NA	Hand Tight
A 15589	Max 70							
A 16302	14 - 18	14 - 18	8 - 12	2 - 3 Threads Exposed	NA	20 - 30	3 - 5	NA
A 16303	14 - 18	14 - 18	8 - 12	2 - 3 Threads Exposed	NA	20 - 30	3 - 5	NA
A 16304	14 - 18	14 - 18	8 - 12	2 - 3 Threads Exposed	NA	20 - 30	3 - 5	NA
A 16307	14 - 18	14 - 18	8 - 12	2 - 3 Threads Exposed	NA	20 - 30	3 - 5	NA
A 16308	14 - 18	14 - 18	8 - 12	2 - 3 Threads Exposed	NA	20 - 30	3 - 5	NA
A 16309	14 - 18	14 - 18	8 - 12	2 - 3 Threads Exposed	NA	20 - 30	3 - 5	NA
A 16310	22 - 40	25 - 45	15 - 25	2 - 3 Threads Exposed	Hand Tight	NA	NA	NA
A 16311	22 - 40	25 - 45	15 - 25	2 - 3 Threads Exposed	Hand Tight	NA	NA	NA
A 16312	22 - 40	25 - 45	15 - 25	2 - 3 Threads Exposed	Hand Tight	NA	NA	NA
A 16313	30 - 40	22 - 45	15 - 25	2 - 3 Threads Exposed	Hand Tight	40 - 50	NA	NA
A 16314	30 - 40	22 - 45	15 - 25	2 - 3 Threads Exposed	Hand Tight	40 - 50	NA	NA
A 16315	30 - 40	22 - 45	15 - 25	2 - 3 Threads Exposed	Hand Tight	40 - 50	NA	NA
A 16316	30 - 40	22 - 45	15 - 25	2 - 3 Threads Exposed	Hand Tight	40 - 50	NA	NA
A 16317	22 - 40	25 - 45	15 - 25	2 - 3 Threads Exposed	Hand Tight	NA	NA	NA
A 16321	45 - 65	45 - 65	25 - 35	2 - 3 Threads Exposed	Hand Tight	NA	NA	Hand Tight
A 16324	45 - 65	45 - 65	35 - 45	2 - 3 Threads Exposed	Hand Tight	NA	NA	Hand Tight
A 16365	45 - 70	45 - 65	55 - 70	2 - 3 Threads Exposed	Hand Tight	NA	NA	Hand Tight
A 16366	45 - 70	45 - 65	55 - 70	2 - 3 Threads Exposed	Hand Tight	NA	NA	Hand Tight
A 16367	45 - 65	45 - 65	35 - 45	2 - 3 Threads Exposed	Hand Tight	NA	NA	Hand Tight
A 16493	45 - 65	45 - 65	35 - 45	2 - 3 Threads Exposed	Hand Tight	NA	NA	Hand Tight
A 16496	45 - 65	45 - 65	25 - 35	2 - 3 Threads Exposed	Hand Tight	NA	NA	Hand Tight
A 17496	Max 70							
B 32197	22 - 40	25 - 45	15 - 25	2 - 3 Threads Exposed	Hand Tight	40 - 50	NA	NA
B 32337	45 - 65	45 - 65	25 - 35	2 - 3 Threads Exposed	Hand Tight	NA	NA	Hand Tight
B 32807	22 - 40	25 - 45	10 - 15	2 - 3 Threads Exposed	Hand Tight	NA	NA	Hand Tight
B 32808	22 - 40	25 - 45	10 - 15	2 - 3 Threads Exposed	Hand Tight	NA	NA	Hand Tight
B 32930	22 - 40	25 - 45	10 - 15	2 - 3 Threads Exposed	Hand Tight	NA	NA	Hand Tight
B 33367	22 - 40	25 - 45	15 - 25	2 - 3 Threads Exposed	Hand Tight	NA	NA	NA
B 33568	45 - 65	45 - 65	35 - 45	2 - 3 Threads Exposed	Hand Tight	NA	NA	Hand Tight
B 33569	45 - 70	45 - 65	55 - 70	2 - 3 Threads Exposed	Hand Tight	NA	NA	Hand Tight
B 33572	45 - 65	45 - 65	35 - 45	2 - 3 Threads Exposed	Hand Tight	NA	NA	Hand Tight
B 33770	45 - 65	45 - 65	25 - 35	2 - 3 Threads Exposed	Hand Tight	NA	NA	Hand Tight
B 33771	45 - 65	45 - 65	35 - 45	2 - 3 Threads Exposed	Hand Tight	NA	NA	Hand Tight
B 33784	45 - 65	45 - 65		2 - 3 Threads Exposed	Hand Tight	NA	NA	Hand Tight
B 33788	50 - 70	50 - 65		2 - 3 Threads Exposed	NA	NA	Hand Tight	Hand Tight
B 33793	45 - 65	45 - 65		2 - 3 Threads Exposed	Hand Tight	NA	NA	Hand Tight
B 33794	Max 70	Max 65		2 - 3 Threads Exposed	NA	NA	Hand Tight	Hand Tight
B 33813	45 - 65	45 - 65		2 - 3 Threads Exposed	Hand Tight	NA	NA	Hand Tight
B 33842	45 - 65	45 - 65	35 - 45	2 - 3 Threads Exposed	Hand Tight	NA	NA	Hand Tight
B 34183	45 - 65	45 - 65	25 - 35	2 - 3 Threads Exposed	Hand Tight	NA	NA	Hand Tight
B 34314	45 - 65	45 - 65		2 - 3 Threads Exposed	NA	NA	Hand Tight	Hand Tight
B 34315	45 - 65	45 - 65		2 - 3 Threads Exposed	NA	NA	Hand Tight	Hand Tight
B 34429	45 - 65	45 - 65		2 - 3 Threads Exposed	Hand Tight	NA	NA	Hand Tight
B 34497	50 - 70	50 - 65		2 - 3 Threads Exposed	NA	NA	Hand Tight	Hand Tight
B 34498	45 - 65	45 - 65		2 - 3 Threads Exposed	Hand Tight	NA	NA	Hand Tight
B 34582	45 - 65	45 - 65		2 - 3 Threads Exposed	Hand Tight	NA	NA	Hand Tight
B 34661	45 - 65	45 - 65		2 - 3 Threads Exposed	NA	NA	Hand Tight	Hand Tight
B 34670	485 - 65	45 - 65		2 - 3 Threads Exposed	NA	NA	Hand Tight	Hand Tight
B 34671	45 - 65	45 - 65		2 - 3 Threads Exposed	Hand Tight	NA	NA	Hand Tight
B 34715	Max 70	Max 65		2 - 3 Threads Exposed	NA	NA	Hand Tight	Hand Tight
B 34929	50 - 70	50 - 65		2 - 3 Threads Exposed	NA	NA	NA	Hand Tight
B 34987					NA	NA	NA	NA
B 34988					NA	NA	NA	NA
B 35049	45 - 65	45 - 65		2 - 3 Threads Exposed	Hand Tight	NA	NA	NA
B 35308	45 - 65	45 - 65		2 - 3 Threads Exposed	Hand Tight	NA	NA	NA
B 35358	45 - 65	45 - 65		2 - 3 Threads Exposed	Hand Tight	NA	NA	NA

COMPRESSORS, CHILLERS & CONDENSERS