

# MOTORS

## BLOWER

### TOTALINE®

#### DIRECT DRIVE



- High or standard efficiency
- 26" Leads
- Permanent split capacitor
- Automatic reset thermal protection
- Class A insulation
- Reversible by electrical reconnection
- 2.25" to 2.50" resilient ring mount
- Open construction, non-ventilated motors for exhaust, air circulators, unit heaters, unit coolers, and other air-over applications.

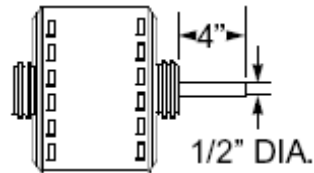

#### THREE SPEED

PART NO	HP	VOLTS	PH	HZ	FLA	THERM PROT	RPM	SPD	ROTAT	BRGS	FRM	SHAFT POS	SHAFT DIA	SHAFT LEN	CAPACITOR MFD/VOLT
P257-8583	1/4	115	1	60	4.2	AUTO	1075	3	REV	SLV	48Y	ALL	1/2	4.0	5/370
P257-8584	1/4	208-230	1	60	2.0	AUTO	1075	3	REV	SLV	48Y	ALL	1/2	4.0	5/370
P257-8585	1/3	115	1	60	6.1	AUTO	1075	3	REV	SLV	48Y	ALL	1/2	4.0	5/370
P257-8586	1/3	208-230	1	60	2.7	AUTO	1075	3	REV	SLV	48Y	ALL	1/2	4.0	5/370
P257-8587	1/2	115	1	60	9.0	AUTO	1075	3	REV	SLV	48Y	ALL	1/2	4.0	5/370
P257-8588	1/2	208-230	1	60	4.3	AUTO	1075	3	REV	SLV	48Y	ALL	1/2	4.0	5/370
P257-8589	3/4	115	1	60	11.2	AUTO	1075	3	REV	SLV	48Y	ALL	1/2	4.0	15/370
P257-8590	3/4	208-230	1	60	5.0	AUTO	1075	3	REV	SLV	48Y	ALL	1/2	4.0	10/370

## Emerson Direct Drive Blower Motors

### Three Speed

#### STANDARD EFFICIENCY

- 24" LEADS
- PERMANANT SPLIT CAPACITOR
- SINGLE PHASE, 60 HERTZ
- SLEEVE BEARINGS
- 2.5" DIA. HUB RINGS
- AUTOMATIC RESET THERMAL PROTECTION
- CLASS A INSULATION
- REVERSIBLE ROTATION

H.P.	Voltage	RPM Speed(S)	FLA	Capactor MFD/Volts	Part No.
1/4	115	1075/3	3.9	5/370	1863
1/4	208-230	1075/3	1.8	5/370	1971
1/3	115	1075/3	5	7.5/370	1864
1/3	208-230	1075/3	2.4	5/370	1972
1/2	115	1075/3	7.4	10/370	1865
1/2	208-230	1075/3	3.3	7.5/370	1973
3/4	115	1075/3	9.1	15/370	8904
3/4	208-230	1075/3	4.6	10/370	8905

# MOTORS

## BLOWER

### TOTALINE®

#### DIRECT DRIVE

#### THREE SPEED - HIGH EFFICIENCY

PART NO	HP	VOLTS	PH	HZ	FLA	THERM PROT	RPM	SPD	ROTAT	BRGS	FRM	SHAFT POS	SHAFT DIA	SHAFT LEN	CAPACITOR MFD/VOLT
P257-8983	1/4	115	1	60	3.7	AUTO	1075	3	REV	SLV	48Y	ALL	1/2	4.0	7.5/370
P257-8984	1/4	208-230	1	60	1.8	AUTO	1075	3	REV	SLV	48Y	ALL	1/2	4.0	5/370
P257-8985	1/3	115	1	60	4.9	AUTO	1075	3	REV	SLV	48Y	ALL	1/2	4.0	7.5/370
P257-8986	1/3	208-230	1	60	2.5	AUTO	1075	3	REV	SLV	48Y	ALL	1/2	4.0	5/370
P257-8987	1/2	115	1	60	7.3	AUTO	1075	3	REV	SLV	48Y	ALL	1/2	4.0	10/370
P257-8988	1/2	208-230	1	60	3.5	AUTO	1075	3	REV	SLV	48Y	ALL	1/2	4.0	7.5/370
P257-8989	3/4	115	1	60	10.3	AUTO	1075	3	REV	SLV	48Y	ALL	1/2	4.0	15/370
P257-8990	3/4	208-230	1	60	5.0	AUTO	1075	3	REV	SLV	48Y	ALL	1/2	4.0	10/370

#### DOUBLE SHAFT FAN

#### PERMANENT SPLIT CAPACITOR

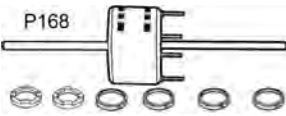

- Rated continuous air over
- Automatic thermal protection
- Extended thru-bolts
- Doubleshaft, 1/2" Dia., 8" each side
- Class B insulation
- 20" leads
- Furnished without run capacitor
- Length adapter kit included to facilitate mounting in cradle type base.

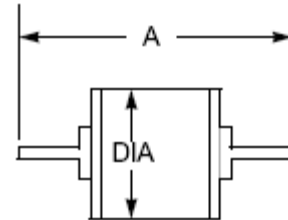

PART NO	HP	VOLTS	PH	HZ	FLA	THERM PROT	RPM	SPD	ROTAT	BRGS	FRM	SHAFT POS	SHAFT DIA	SHAFT LEN	DIA	A	CAPACITOR MFD/VOLT
P257-8651	1/6	115	1	60	2.4	AUTO	1075	3	CCW	SLV	48Y	ALL	1/2	8.0/8.0	5.6	20.0	5/370
P257-8652	1/6	208-230	1	60	1.0	AUTO	1075	3	CCW	SLV	48Y	ALL	1/2	8.0/8.0	5.6	20.0	5/370
P257-8671	1/4	115	1	60	3.7	AUTO	1075	3	CCW	SLV	48Y	ALL	1/2	8.0/8.0	5.6	20.0	5/370
P257-8672	1/4	208-230	1	60	1.7	AUTO	1075	3	CCW	SLV	48Y	ALL	1/2	8.0/8.0	5.6	20.0	5/370
P257-8872	1/4	208-230	1	60	1.2	AUTO	1625	3	CCW	SLV	48Y	ALL	1/2	8.0/8.0	5.6	20.0	5/370
P257-8682	1/3	208-230	1	60	2.5	AUTO	1075	3	CCW	SLV	48Y	ALL	1/2	8.0/8.0	5.6	20.0	5/370
P257-8882	1/3	208-230	1	60	1.9	AUTO	1625	3	CCW	SLV	48Y	ALL	1/2	8.0/8.0	5.6	20.0	5/370
P257-8692	1/2	208-230	1	60	3.5	AUTO	1075	3	CCW	SLV	48Y	ALL	1/2	8.0/8.0	5.6	20.0	7.5/370
P257-8892	1/2	208-230	1	60	3.0	AUTO	1625	3	CCW	SLV	48Y	ALL	1/2	8.0/8.0	5.6	20.0	5/370

# MOTORS

## BLOWER

### TOTALINE®

#### BELTED

#### SPLIT PHASE

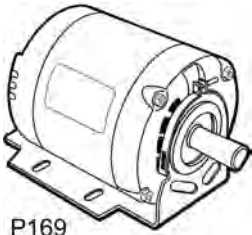

P169

- NEMA Service Factors
- Open drip-proof construction
- 40°C ambient
- Reversible rotation by electrical reconnection
- Class A insulation - 1/6 thru 1/2 H.P.
- Class B insulation - 3/4 thru 1 H.P.
- All 5/8" dia. shaft motors are keyed.

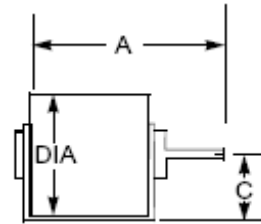

The following motors mounting holes are combination 48 & 56, shaft height is 3.0", includes 5/8" dia. shaft adapter:

- P267-9305 • P267-9758 • P267-9308

PART NO	HP	VOLTS	PH	HZ	FLA	SF	THERM PROT	RPM	SPD	ROTAT	BRGS	FRM	SHAFT DIA	SHAFT LEN	DIA	A	C
P267-9305	1/4	115	1	60	4.4	1.35	AUTO	1725	1	REV	SLV	48(R)	1/2	1.5	5.6	9.4	3.0
P267-9308	1/3	115	1	60	5.4	1.35	AUTO	1725	1	REV	SLV	48(R)	1/2	1.5	5.6	9.9	3.0
P267-9309	1/3	230	1	60	2.7	1.35	AUTO	1725	1	REV	SLV	48(R)	1/2	1.6	5.7	9.9	3.0
P267-9758	1/2	115	1	60	7.9	1.25	AUTO	1725	1	REV	BALL	48(R)	1/2	1.5	5.6	9.9	3.0
P267-9392	1/2	115	1	60	8.0	1.25	AUTO	1725	1	REV	SLV	56(R)	5/8	2.0	6.5	9.8	3.5
P267-D136	1/2	115/230	1	60	8.0/4.0	1.25	AUTO	1725	1	REV	SLV	56(R)	5/8	2.0	6.5	9.8	3.5
P267-D231	3/4	115	1	60	11.8	1.25	AUTO	1725	1	REV	SLV	56(R)	5/8	2.0	6.5	9.8	3.5
P267-D232	3/4	230	1	60	5.6	1.25	AUTO	1725	1	REV	SLV	56(R)	5/8	2.0	6.5	9.8	3.5

#### CAPACITOR START

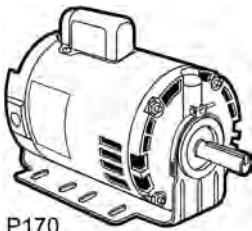

P170

- NEMA Service Factors
- Resilient mount
- Open drip-proof construction
- 40°C ambient
- Class A insulation - 1/2 H.P.
- Class B insulation - 3/4 and 1 H.P.
- Reversible rotation by electrical reconnection

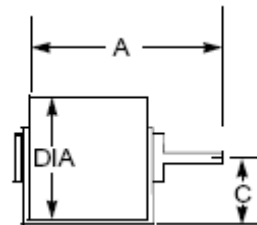

PART NO	HP	VOLTS	PH	HZ	FLA	SF	THERM PROT	RPM	SPD	ROTAT	BRGS	FRM	SHAFT DIA	SHAFT LEN	DIA	A	C
P268-E223	1/2	115/230	1	60	8.6/4.3	1.25	AUTO	1725	1	REV	BALL	56	5/8	2.0	5.6	9.3	3.5
P268-E231	3/4	115/230	1	60	11.4/5.7	1.25	AUTO	1725	1	REV	BALL	56	5/8	2.0	5.6	10.8	3.5
P268-E236	1	115/230	1	60	13.0/6.5	1.15	AUTO	1725	1	REV	BALL	56	5/8	2.0	6.2	11.8	3.5